

# 晋江市东石污水处理厂项目用地勘测界图

2727.4-40343.6

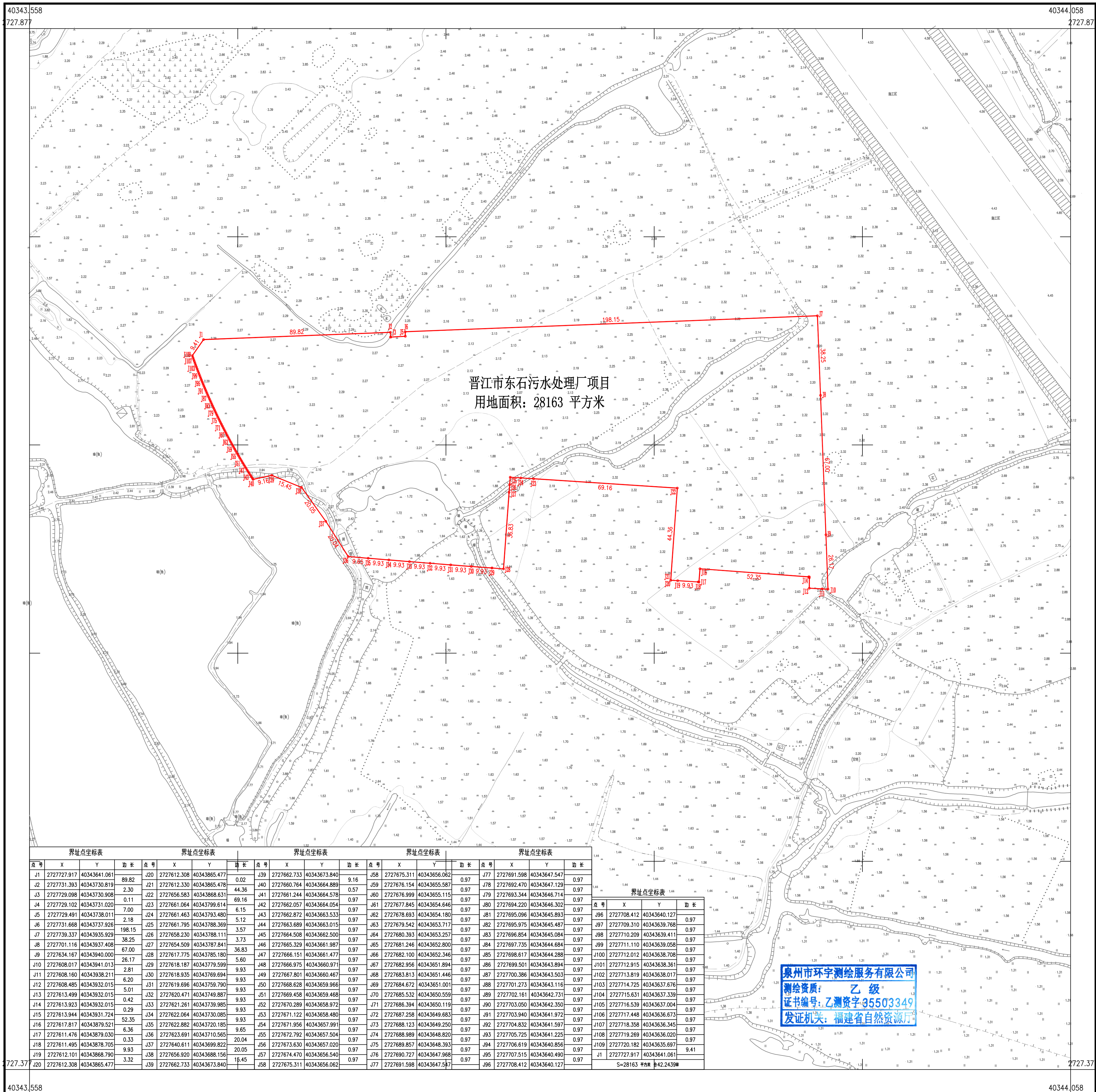
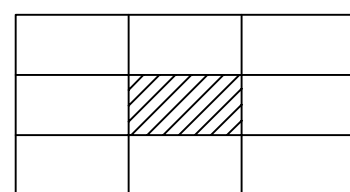

晋江市东石污水处理厂项目  
用地面积: 28163 平方米

界址点坐标表			界址点坐标表			界址点坐标表			界址点坐标表			界址点坐标表			
点号	X	Y	边长	点号	X	Y	边长	点号	X	Y	边长	点号	X	Y	边长
J1	2727727.917	40343641.061	89.82	J20	2727612.308	40343865.477	0.02	J39	2727662.733	40343673.840	9.16	J58	2727675.311	40343656.062	0.97
J2	2727731.393	40343730.819	2.30	J21	2727612.330	40343865.478	44.36	J40	2727660.764	40343664.889	0.57	J59	2727676.154	40343655.587	0.97
J3	2727729.098	40343730.908	0.11	J22	2727656.583	40343868.631	69.16	J41	2727661.244	40343664.578	0.97	J60	2727676.999	40343655.115	0.97
J4	2727729.102	40343731.020	7.00	J23	2727661.064	40343799.614	6.15	J42	2727662.057	40343664.054	0.97	J61	2727677.845	40343654.646	0.97
J5	2727729.491	40343738.011	2.18	J24	2727661.463	40343793.480	5.12	J43	2727662.872	40343663.533	0.97	J62	2727678.693	40343654.180	0.97
J6	2727731.668	40343737.926	198.15	J25	2727661.795	40343788.369	3.57	J44	2727663.689	40343663.015	0.97	J63	2727679.542	40343653.717	0.97
J7	2727739.337	40343935.929	38.25	J26	2727658.230	40343788.111	3.73	J45	2727664.508	40343662.500	0.97	J64	2727680.393	40343653.257	0.97
J8	2727701.116	40343937.408	67.00	J27	2727654.509	40343787.841	36.83	J46	2727665.329	40343661.987	0.97	J65	2727681.246	40343652.800	0.97
J9	2727634.167	40343940.000	26.17	J28	2727617.775	40343785.180	5.60	J47	2727666.151	40343661.477	0.97	J66	2727682.100	40343652.346	0.97
J10	2727608.017	40343941.013	2.81	J29	2727618.187	40343779.599	9.93	J48	2727666.975	40343660.971	0.97	J67	2727682.956	40343651.894	0.97
J11	2727608.160	40343938.211	6.20	J30	2727618.935	40343769.694	9.93	J49	2727667.801	40343660.467	0.97	J68	2727683.813	40343651.446	0.97
J12	2727608.485	40343932.015	5.01	J31	2727619.696	40343759.790	9.93	J50	2727668.628	40343659.966	0.97	J69	2727684.672	40343651.001	0.97
J13	2727613.499	40343932.015	0.42	J32	2727620.471	40343749.887	9.93	J51	2727669.458	40343659.468	0.97	J70	2727685.532	40343650.559	0.97
J14	2727613.923	40343932.015	0.29	J33	2727621.261	40343739.985	9.93	J52	2727670.289	40343658.972	0.97	J71	2727686.394	40343650.119	0.97
J15	2727613.944	40343931.724	52.35	J34	2727622.064	40343730.085	9.93	J53	2727671.122	40343658.480	0.97	J72	2727687.258	40343649.683	0.97
J16	2727617.817	40343879.521	6.36	J35	2727622.882	40343720.185	9.65	J54	2727671.956	40343657.991	0.97	J73	2727688.123	40343649.250	0.97
J17	2727611.476	40343879.030	0.33	J36	2727623.691	40343710.565	20.04	J55	2727672.792	40343657.504	0.97	J74	2727688.989	40343648.820	0.97
J18	2727611.495	40343878.705	9.93	J37	2727640.611	40343699.822	20.05	J56	2727673.630	40343657.020	0.97	J75	2727689.857	40343648.393	0.97
J19	2727612.101	40343868.790	3.32	J38	2727656.920	40343688.156	15.45	J57	2727674.470	40343656.540	0.97	J76	2727690.727	40343647.968	0.97
J20	2727612.308	40343865.477		J39	2727662.733	40343673.840		J58	2727675.311	40343656.062	0.97	J77	2727691.598	40343647.547	0.97

点号	X	Y	边长
J96	2727708.412	40343640.127	0.97
J97	2727709.310	40343639.768	0.97
J98	2727710.209	40343639.411	0.97
J99	2727711.110	40343639.058	0.97
J100	2727712.012	40343638.708	0.97
J101	2727712.915	40343638.361	0.97
J102	2727713.819	40343638.017	0.97
J103	2727714.725	40343637.676	0.97
J104	2727715.631	40343637.339	0.97
J105	2727716.539	40343637.004	0.97
J106	2727717.448	40343636.673	0.97
J107	2727718.358	40343636.345	0.97
J108	2727719.269	40343636.020	0.97
J109	2727720.182	40343635.697	0.97
J110	2727721.097	40343635.374	0.97
J111	2727722.012	40343635.051	0.97
J112	2727722.927	40343634.728	0.97
J113	2727730.050	40343642.350	0.97
J114	2727703.940	40343641.972	0.97
J115	2727704.832	40343641.597	0.97
J116	2727705.725	40343641.225	0.97
J117	2727706.619	40343640.856	0.97
J118	2727707.515	40343640.480	0.97
J119	2727708.412	40343640.127	0.97

**泉州市环宇测绘服务有限公司**  
 测绘资质: **乙级**  
 证书编号: **乙测资字35503349**  
 发证机关: **福建省自然资源厅**

泉州市环宇测绘服务有限公司